

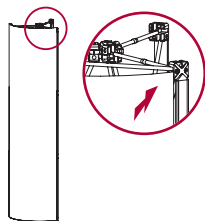

- Unwrap the magnetic bars and attach them to the magnets in the hubs. The structure is ready for installing the graphics.



Never slide the magnetic bars on top of each other, it would damage the magnetic field!!!



- It is advisable to allow the graphic panels to lie flat for about 30 min. before placing onto the structure.

- The graphic panels are attached by hanging the magnetic hanger onto the magnets in the top row of hubs.

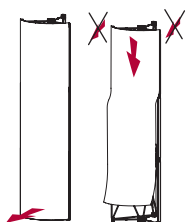

dismantling:

- When dismantling the panels, please follow the picture.

Graphic panels can be cleaned using water and detergent; laminated panels can also be cleaned with an alcohol-based cleaner.

Always roll up the graphic panels with the print on the outside!

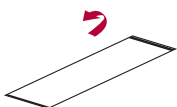

EUROtower round

instruction manual



TOWER ROUND



- Remove the structure from the packaging and place it on the floor, so that the hubs with hinges are on the top.



- Open the structure following the picture.
- Connect the short magnetic lockers.

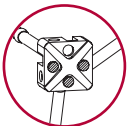
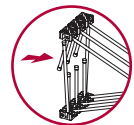

- Stand the structure up, so that the row of hubs with 3 magnets is at the top.



- Expand the structure to its full size following the picture.
- Connect the long magnetic lockers.

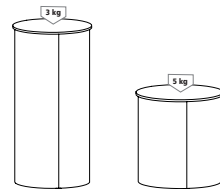
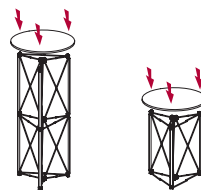
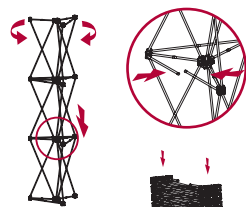

- When dismantling the structure disconnect the long magnetic lockers into the center and fold the structure following the picture.

Please note:

- A top desk is available for EUROtowers 1 and 2. It is to be placed onto the metal rods on the top of the tower.

- Max. load: 3 kg
- Max. load: 5 kg

- To attach the lights use the triangular connector for lights.

packaging



Flight bag for graphic panels.

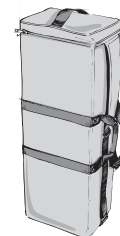

Flight bag for structure.

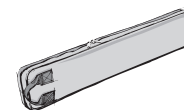

Transport bag for magnetic bars.

Notice:
For interior use only!